

WSAA PRODUCT APPRAISAL CERTIFICATE

Gillies Metaltech Limited Resilient Seated Gate Valves

This appraisal is for a range of Gillies PN16 flanged resilient seated gate valves.

The valves are available with optional clockwise or anticlockwise closure directions.

This Issue 2 is to include DN 300 valves.

The size range includes DN 100, DN 150, DN 200 and DN 250 and DN 300.

Flanges conform to AS/NZS 4087 Fig B5 PN16.

Quality Certification and product details are listed in Schedules A and B.

Product Category	Resilient Seated Gate Valves
PA Number:	PA 2508 Issue 2
Supplier	Gillies Metaltech Limited
Brand	Gillies
Standards	AS/NZS 2638.2:2011 <i>Gate valves for waterworks purposes, Part 2: Resilient seated</i>
WSAA Product Specification	WSA PS 260 <i>Gate Valves, Resilient Seated for Pressure Applications – Drinking Water, Non-Drinking Water Supply and Sewerage</i>
Issue date	25 July 2025
Expiry date	2 July 2030
Recommendations	It is recommended that WSAA members, subject to any specific requirements of the member, accept or authorise the Gillies range of resilient seated gate valves, as detailed in this report, for use in water supply and sewerage pressure pipelines, provided they are installed in accordance with WSAA Codes and the manufacturers requirements, where specified
Disclaimer	The disclaimer on Page 2 explains a number of very important limits on your ability to rely on the information in this Product Appraisal Certificate and the assessment criteria used to underlie it. Please read it carefully and take into account when considering the content in this Certificate.

1. Disclaimer

This Product Appraisal Certificate (Certificate) is issued by WSAA on the understanding that:

This Certificate applies to the product(s) as submitted in Schedule A. Any changes to the product(s) either minor or major shall void this Certificate.

To maintain the recommendations of this Certificate any such changes shall be detailed and notified to the Product Appraisal Manager for consideration and review of the Certificate including the product appraisal criteria underlying it and appropriate action. Appraisals and their recommendations will be the subject of continuous review dependent upon the satisfactory performance of products.

WSAA reserves the right to undertake random audits of product manufacture and installation. Where products fail to maintain appraised performance requirements the appraisal and its recommendations may be modified and reissued. Certificates will be reviewed and reissued at regular intervals not exceeding five (5) years.

WSAA reserves the right to withdraw this Certificate at any time in its sole and absolute discretion for any reason.

The following information explains a number of very important limits on your ability to rely on the information in this Certificate. Please read it carefully and take it into account when considering the contents of this Certificate.

Any enquiries regarding this Certificate should be directed to the Product Appraisal Manager Phone: 03 8605 7601 email carl.radford@wsaa.asn.au.

1.1. Issue of Certificate

This Certificate has been published and/or prepared by WSAA and nominated Project Manager and peer group of technical specialists (the Publishers).

The Certificate and the underlying product appraisal criteria have been prepared for use within Australia only by technical specialists that have expertise in the function of products such as those appraised in the Certificate (the Recipients).

By accepting this Certificate, the Recipient acknowledges and represents to the Publisher(s) and each person involved in the preparation of the Certificate and product appraisal criteria underlying it that the Recipient has understood and accepted the terms of this Disclaimer.

1.2. Limits on Reliance on Information and Recommendations

1.2.1. Disclaimer of liability

Neither the Publisher(s) nor any person involved in the preparation of the Certificate and product appraisal criteria underlying it accept(s) any liability for any loss or damage suffered by any person however caused (including negligence or the omission by any person to do anything) relating in any way to the Certificate or the product appraisal criteria underlying it. This includes (without limitation) any liability for any recommendation or information in the Certificate or any errors or omissions.

1.2.2. Intellectual Property and other rights

WSAA does not undertake any assessment of whether the importation, manufacture, sale or use of the Product the subject of this Certificate infringes the intellectual property rights or proprietary rights of any person. Recipients of the Certificate should undertake their own assessment of whether (as relevant) the importation, manufacture, sale or use of the relevant Products infringe the intellectual property rights or other proprietary rights of any person. If the Product infringes intellectual property rights or other proprietary rights there is potential for the supply of the Products to be interrupted.

From time to time WSAA and the other Publishers may receive notice of allegations that the importation, manufacture, sale or use of the Product infringes intellectual property rights or other proprietary rights. WSAA's policy is to not refer to such allegations in its Certificate or take any other steps to put Recipients on notice of such allegations. If, however, WSAA becomes aware that the allegations have been admitted or proved in Court, then WSAA may, at its discretion, take such steps as it considers appropriate. As such, Recipients acknowledge, agree and accept that WSAA may have information in its possession about intellectual property rights infringement allegations or other infringement allegations in relation to the Product which are not referred to or disclosed in this Certificate and which are not otherwise communicated to Recipients.

1.2.3. Need for independent assessment

The information and any recommendation contained (expressly or by implication) in this Certificate are provided in good faith (and subject to the limitations noted in this Certificate). However, you should treat the information as indicative only. You should not rely on that information or any such recommendation except to the extent that you reach an agreement to the contrary with the Publisher(s).

This Certificate does not contain all information that a person might require for the purposes of assessing any product discussed or appraised within it. The product appraisal criteria used in preparing this Certificate may not address all relevant aspects of the Product.

Recipients should seek independent evidence of any matter which is material to their decisions in connection with an assessment of the Product and consult their own advisers for any technical information required. Any decision to use the Product should take into account the reliability of that independent evidence obtained by the Recipient regarding the Product. Recipients should also independently verify and assess the appropriateness of any recommendation in the Certificate, especially given that any recommendation will not take into account a Recipient's particular needs or circumstances.

WSAA has not evaluated the extent of the product liability and professional indemnity insurance that the provider of the product maintains. Recipients should ensure that they evaluate the allocation of liability for product defects and any professional advice obtained in relation to the product or its specification including the requirements for product liability and professional indemnity insurance.

1.3. No Updating

Neither the Publisher(s) nor any person involved in the preparation of this Certificate or the product appraisal criteria underlying it [has] [have] any obligation to notify you of any change in the information contained in this Certificate or of any new information concerning the Publisher(s) or the Product or any other matter.

1.4. No Warranty

The Publisher(s) do[es] not, in any way, warrant that steps have been taken to verify or audit the accuracy or completeness of the information in this Certificate, or the accuracy, completeness or reasonableness of any recommendation in this Certificate.

QUALITY CERTIFICATIONS

Copies of the following Quality Certificates are available from the WSAA.

SCHEDULE A1 GILLIES METALTECH LTD – MANAGEMENT SYSTEMS

28 Tyne Street Oamaru NZ	
Quality Systems Standard	ISO 9001:2015
Certification Licence No.	NZ001986-1
Certifying Agency	Bureau Veritas
First Date of Certification	17 July 2008
Current Date of Certification	17 July 2023
Expiry Date of Certification	17 July 2026

SCHEDULE A2 HYNDS LTD – MANAGEMENT SYSTEMS

25 Arwen Place East Tamaki Auckland NZ	
Quality Systems Standard	ISO 9001:2015
Certification Licence No.	2641
Certifying Agency	Telarc
First Date of Certification	18 March 1994
Current Date of Certification	10 October 2022
Expiry Date of Certification	14 October 2025

SCHEDULE A3 GILLIES METALTECH LTD – PRODUCT CERTIFICATION

28 Tyne Street Oamaru NZ	
Product Standard/Spec.	AS/NZS 2638.2:2011
Certificate No.	4085
Issuing Certification Body	Pro-Switch
First Date of Certification	10 March 2025
Current Date of Certification	17 July 2025
Expiry Date of Certification	10 March 2030



PRODUCT LITERATURE



Gillies Resilient Seated Gate Valves

Gillies Resilient Seated Gate Valves are designed and manufactured to AS/NZS 2638.2. These valves are suitable for use in potable water and for installation above or below ground.



TECHNICAL GUIDE: **AVH1.32**

Applications

Potable water networks
Bulk water storage
Process water systems
Pump stations
Neutral liquids without solids

Product Attributes

PN16 Rated
Available as Anti-Clockwise and Clockwise Closing
Smooth straight through bore
Suitable for actuation

Approvals/Standards

AS/NZS 2638.2:2011 Gate Valves for Water Works – Resilient Seated
Flanges drilled to AS/NZS 4087 Fig. B5
Coating complies with AS/NZS 4158 and AS/NZS 4020 for potable water



Licence Number:
WMK23494

Quality

ISO 9001:2015 Quality Management Systems



Gillies Resilient Seated Gate Valves are manufactured from high strength and corrosion resistant materials to provide reliable service in potable water networks. These valves are PN16 rated, available in DN80 – DN600 as anti-clockwise or clockwise closing.

Product Features

- Suitable for above ground or underground installation.
- Anti-clockwise closing or clockwise closing available.
- Smooth straight-through bore prevents debris build up and allows for easy cleaning with a pig.
- Ductile Iron body and bonnet for high strength and impact resistance.
- Ductile Iron wedge fully encapsulated by EPDM elastomer to ensure a drip tight seal.
- Spindle O-Rings are replaceable under operating pressure.
- Fusion Bonded Epoxy coating to AS/NZS 4158 provides long lasting corrosion protection.
- 431 Grade Stainless Steel Stem and 316 Grade Stainless Steel Bolts for high corrosion resistance.

Accessories

- Supplied with Spindle Cap as standard.
- Handwheels available as optional.
- Actuator Adaptor with ISO flange drilling available as optional.

Technical Specifications

- Size Range: DN80 – DN600
- Complies with AS/NZS 2638.2:2011
- Flanges drilled to AS/NZS 4087 Fig. B5
- Coating complies with AS/NZS4158
- Potable water compliant to AS/NZS 4020
- Maximum operating temperature: 40°C
- Allowable operating pressure: 16 Bar
- Complies with Low Lead Requirements in accordance to Section G12 of the New Zealand Building Code.

Installation

- Suitable for above or below ground installation in accordance to relevant local authority requirements and regulatory codes.



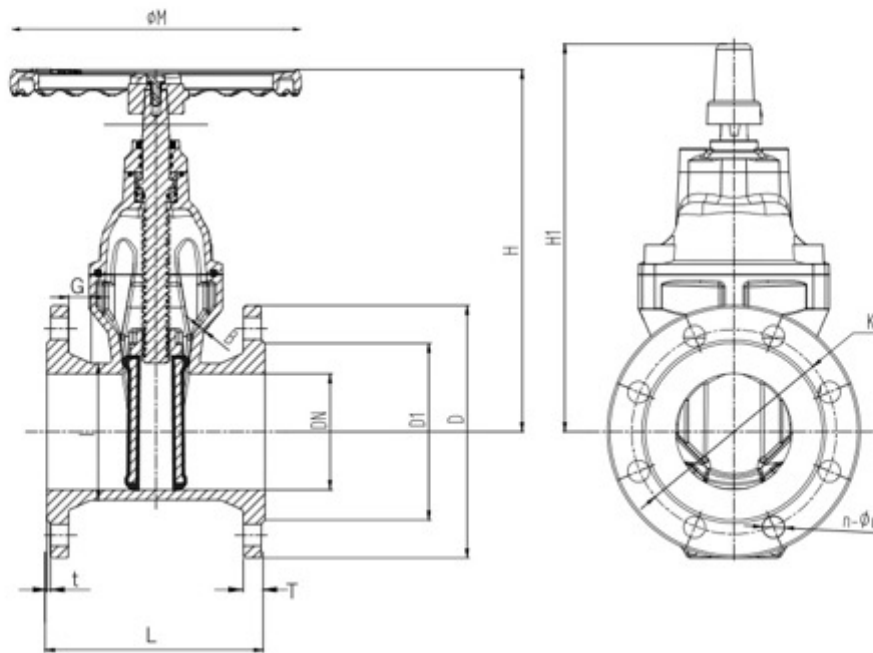

Code	DN	CONNECTING FLANGE							Turns to Close	Closing Torque (Nm)	M	H	H1	Weight (kg)
		L	D	D1	K	n-Ød	T	t						
VGRS080	80	203	185	122	146	4-Ø18	18	3	11	60	Ø200	275	290	12
VGRS100	100	229	215	154	178	4-Ø18	20	3	12	80	Ø220	320	335	19
VGRS150	150	267	280	211	235	8-Ø18	23	3	17	120	Ø280	400	410	33
VGRS200	200	292	335	268	292	8-Ø18	23	3	18.5	150	Ø315	495	545	50
VGRS225	225	305	370	300	324	8-Ø18	24	3	23	200	Ø406	555	545	76
VGRS250	250	330	405	328	356	8-Ø22	24	3	23	200	Ø406	590	460	79
VGRS300	300	356	455	378	406	12-Ø22	30	4	27	250	Ø406	670	720	107
VGRS375	375	381	550	463	495	12-Ø26	33	4	34	350	Ø500	820	900	211
VGRS450	450	432	640	552	584	12-Ø26	33	4	28	400	Ø650	980	1030	293
VGRS500	500	457	705	609	641	16-Ø26	35	4	32	450	Ø650	1050	1100	354
VGRS600	600	508	825	720	756	16-Ø30	42	5	34	550	Ø650	1245	1295	586

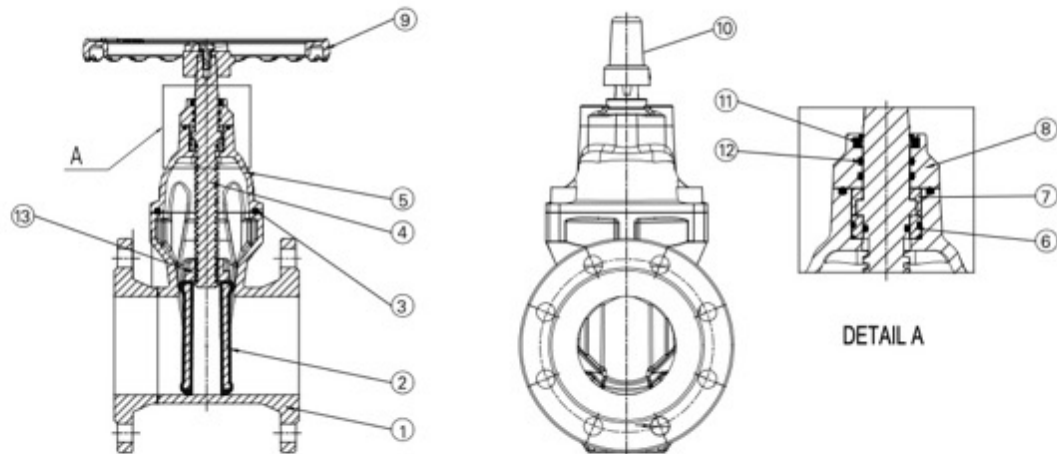

No.	Component	Material
1	Body	Ductile Iron (500-7)
2	Wedge	EPDM + Ductile Iron (500-7)
3	Bonnet Gasket	EPDM (WRAS)
4	Stem	AISI431 Stainless Steel
5	Bonnet	Ductile Iron (500-7)
6	Thrust Washer	Bronze (C95210)
7	Thrust Sleeve	Bronze (C95210)
8	Gland	CF8M Stainless Steel
9&10	Handwheel/Cap	Ductile Iron (500-7)
11	Dustcover	NBR
12	O-Ring	EPDM (WRAS)
13	Stem Nut	Bronze (C95210)



Scan for more
information

Disclaimer: While every effort has been made to ensure that the information in this document is correct and accurate, users of Hygrade Water Infrastructure product or information within this document must make their own assessment of suitability for their particular application. Product dimensions are nominal only, and should be verified if critical to a particular installation. No warranty is either expressed, implied, or statutory made by Hygrade Water Infrastructure unless expressly stated in any sale and purchase agreement entered into between Hygrade Water Infrastructure and the user.

June 2025

+61 7 38059186
hygradewater.com.au

BRISBANE (Head Office) 42-44 Blue Eagle Drive, Meadowbrook, QLD 4131
SYDNEY 2/35 Prime Dr, Seven Hills NSW 2147, Australia
MELBOURNE 20A Frances Drive, Dandenong South 3175

HW HYGRADE WATER
INFRASTRUCTURE



SUPPLIER CONTACTS

Hygrade Water Australia

42-44 Blue Eagle Drive

Meadowbrook QLD Australia 4131

Phone: +61 7 3805 9186

Email: sales@hygradewater.com.au

Website: www.hygradewater.com.au